



ET58

Tracked Conventional Excavator

Powerful, comfortable and safer

Full speed ahead: The ET58 mini excavator combines proven technology with a large dose of innovation to become a champion in the 5-6-metric-ton class. It has the usual high lifting and digging forces as well as fast work cycles. Thanks to the latest technologies, emissions have been reduced and efficiency has been increased at the same time. The powerful engine meets the Stage 5 emission standards. The excavator also makes an impression in terms of user-friendliness. Work is easy and comfortable due to the intuitive operating concept and the excellent view of the working area.

Highlights

- Flexible cylinder rod protection
- 3-point kinematics
- Active Working Signal (AWS)
- Up to 5 additional control circuits ex work
- Load Sensing Flow Sharing

Technical Data

Hydraulic

| | |
|-------------------------------|-------------------|
| Operating pressure hydraulics | 245.0 bar |
| Hydraulic pump | Axial piston pump |
| Flow rate | 126.0 l/min |
| Flow rate max. | 132.0 l/min |

Mechanical - Output Details

| | |
|--------------|----------|
| Travel speed | 4.4 km/h |
|--------------|----------|

Mechanical Details

| | |
|------------------------------|----------------------|
| Length | 6,050.0 mm |
| Width | 1,960.0 mm |
| Height | 2,667.0 mm |
| Weight | 4,617.00 kg |
| Operating weight (min.-max.) | 5,052.0 - 6,386.0 kg |
| Digging depth (max.) | 4,017.0 mm |

Engine

| | |
|-------------|---------------|
| Cooling | Water-cooling |
| Engine type | Diesel engine |

| | |
|-------------------------------|-------------------------|
| Cylinder | 3.0 |
| Cylinder capacity | 1,662.0 cm ³ |
| Inclined position max. | 30.0 ° |
| Fuel | Diesel EN 590 |
| Effective power | 33.5 KW |
| Nominal Engine speed | 2,100.0 1/min |
| Exhaust-gas limit | EU Stage V |
| Battery capacity (nom. value) | 77.0 Ah |
| Engine Manufacturer | Perkins |
| Engine Designation | 403J-E17T |

Environment Data

| | |
|-----------------------------|------------|
| Sound power LWA, guaranteed | 97.0 dB(A) |
|-----------------------------|------------|

Chassis

| | |
|----------------|-----------------------------|
| Traction drive | Axial piston motor with RGU |
|----------------|-----------------------------|

Shipping and Storage

| | |
|-----------------|------------|
| Shipping weight | 4,817.0 kg |
|-----------------|------------|

Dimensions

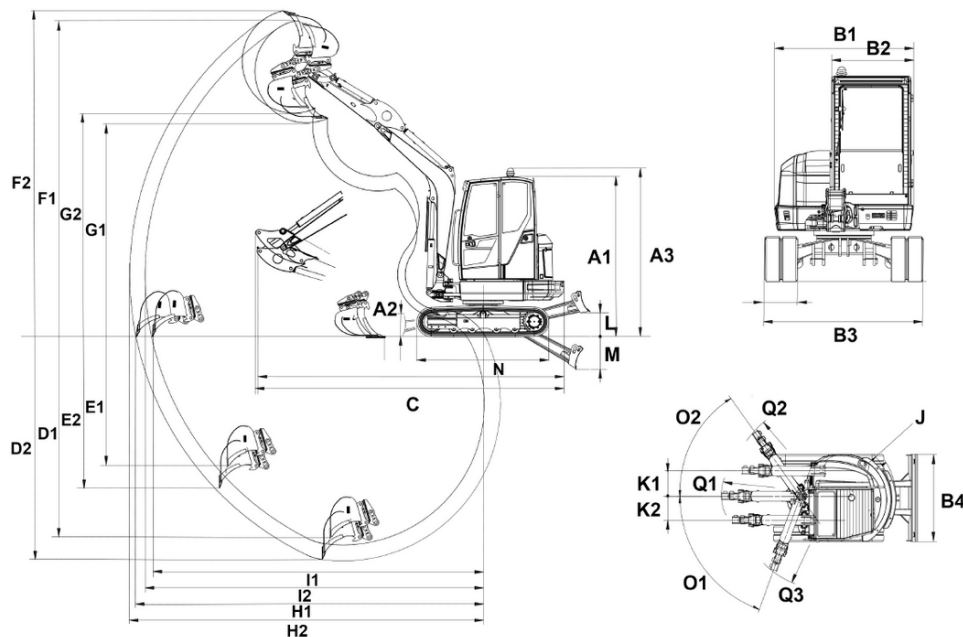

| | | |
|----|---|----------|
| A1 | Height with cab | 2,550 mm |
| A2 | Height of dozer blade | 428 mm |
| A3 | Total height with rotating beacon | 2,661 mm |
| B1 | Width of upper carriage | 1,719 mm |
| B2 | Width of cab | 980 mm |
| B3 | Width travel gear | 1,960 mm |
| B4 | Width of dozer blade | 1,960 mm |
| C | Transport length short shovel arm | 5,455 mm |
| | Transport length long shovel arm | 5,446 mm |
| D1 | Digging depth max., short shovel arm | 3,767 mm |
| D2 | Digging depth max., long shovel arm | 4,017 mm |
| E1 | Piercing depth max., short shovel arm | 2,708 mm |
| E2 | Piercing depth max., long shovel arm | 2,945 mm |
| F1 | Piercing height max., short shovel arm | 5,749 mm |
| F2 | Piercing height max., long shovel arm | 5,910 mm |
| G1 | Dumping height max., short shovel arm | 3,834 mm |
| G2 | Dumping height max., long shovel arm | 3,995 mm |
| H1 | Digging radius max., short shovel arm | 6,039 mm |
| H2 | Digging radius max., long shovel arm | 6,277 mm |
| I1 | Max. reach at ground level (short shovel arm) | 5,920 mm |
| I2 | Max. reach at ground level (long shovel arm) | 6,164 mm |
| J | Tail swing radius | 1,312 mm |
| | Tail swing radius with tail weight | 1,417 mm |
| K1 | Boom offset max. (to center of bucket right side) | 551 mm |
| K2 | Boom offset max. (to center of bucket left side) | 583 mm |
| L | Stacking height max. (dozer blade above surface) | 414 mm |
| M | Digging depth max. (dozer blade below surface) | 439 mm |
| N | Length travel drive | 2,509 mm |
| O1 | Max. swivel angle (arm system to the left) | 70 ° |
| O2 | Max. swivel angle (arm system to the right) | 55 ° |
| Q1 | Boom swing radius center | 2,409 mm |
| Q2 | Boom swing radius right | 2,275 mm |
| Q3 | Boom swing radius left | 2,022 mm |