

SERIES 25

Stainless Steel Channel Gates

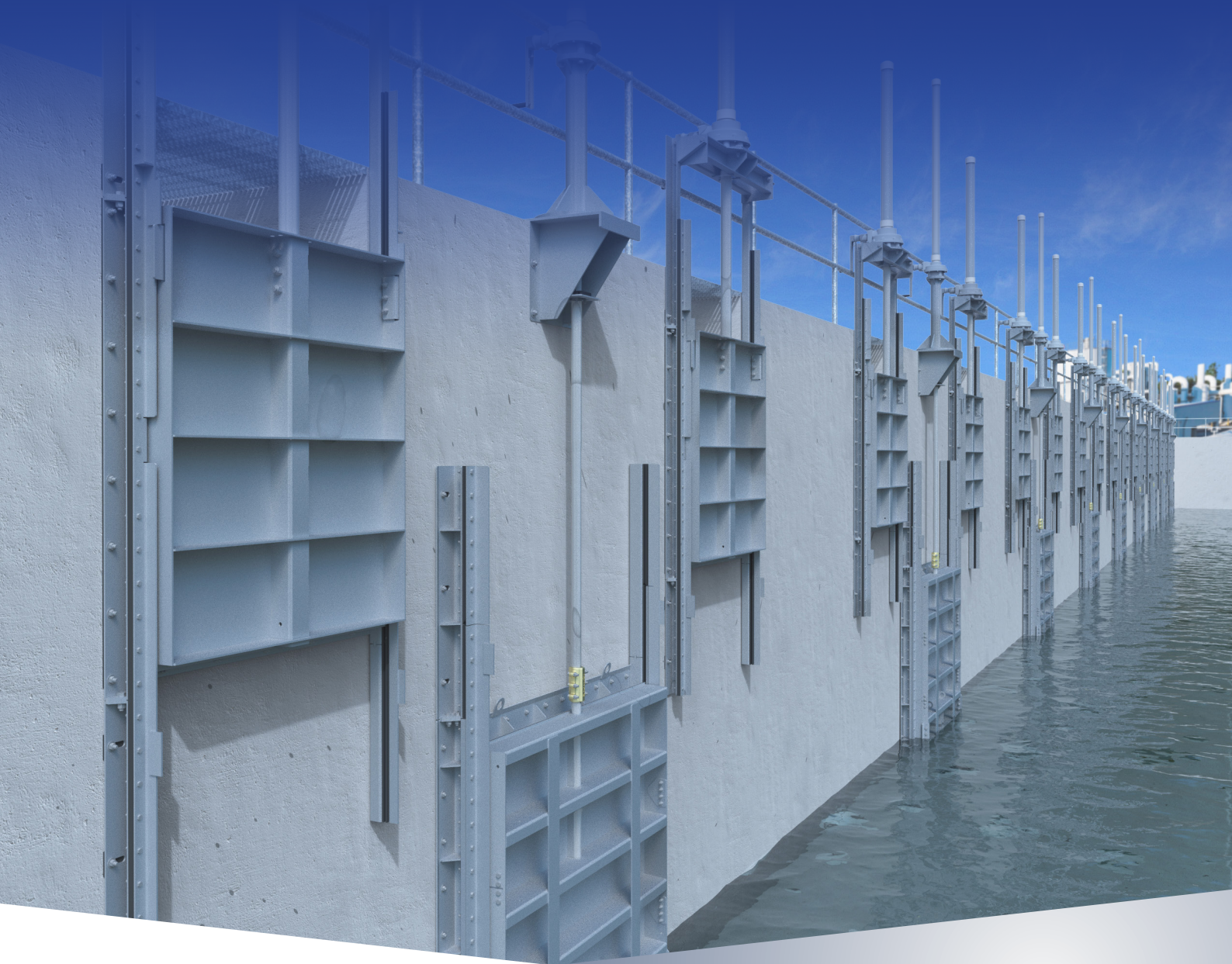

Application

The Fontaine-Aquanox **SERIES 25** gate is designed to control water flows in channels. It is the same construction as the Series 20 with the exception that it is not equipped with a top seal. The maximum allowable leakage is 0.04 US GPM per foot (0.5 l/min per meter) of perimeter in seating and unseating head conditions (head conditions taken is equal to the height of the slide).

Stainless steel construction

Because of its Stainless Steel construction, the **SERIES 25** has a very good corrosion and erosion resistance and can be operated many years with minimum maintenance. The Stainless Steel construction allows a very large design flexibility, the result being a lighter weight and easier-to-install channel gate.



Typical Series 25 installation



No	Part	Material
1	Frame	Stainless steel ASTM A-240 Type 304L or 316L
2	Guides	Ultra high molecular weight polyethylene (UHMWPE) ASTM D-4020
3	Compression cord	EPDM
4	Bottom seal	EPDM
5	Slide	Stainless steel ASTM A-240 Type 304L or 316L
6	Yoke	Stainless steel ASTM A-240 Type 304L or 316L

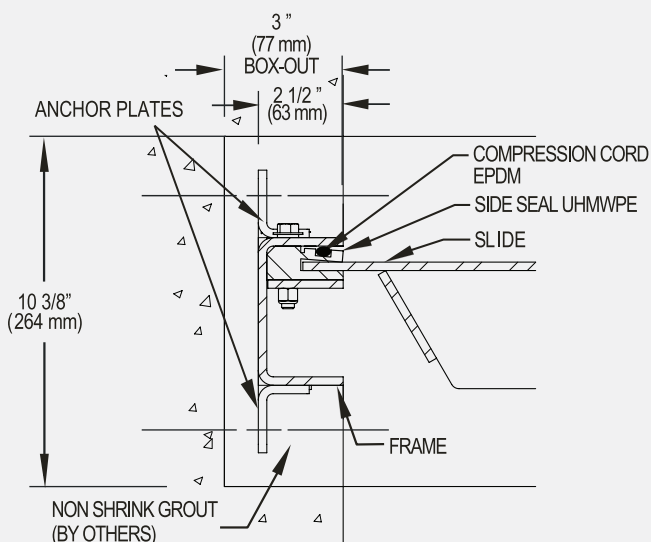
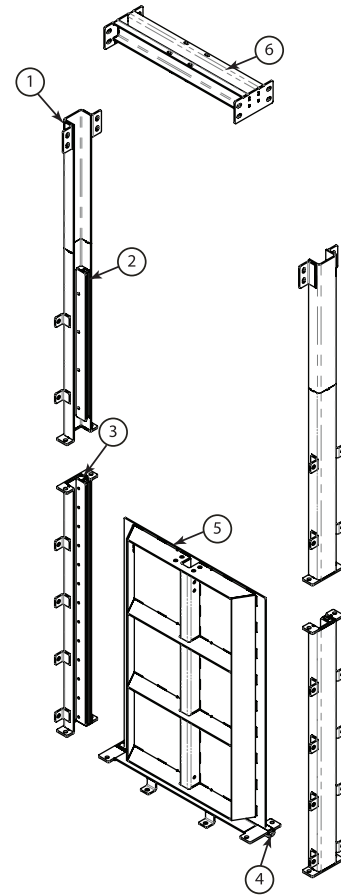

Fig. 25-01
Side section of an embedded frame gate (FE)

UHMWPE Seals

The unique side seals of the **SERIES 25** are the same as on the **SERIES 20** and allow no metal-to-metal contact. They are made of a selflubricating ultra high molecular weight polyethylene (UHMWPE). With a friction coefficient of 0.2, the seals make the gate easy to open even when not operated for a long period. The self-adjusting quality is obtained by a compression cord that guarantees a perfect watertight seal between the slide and the frame in both seating and unseating conditions. The seals extend all the way to the top of the frame making the **SERIES 25** a water control gate in addition to having the characteristics of a channel gate.

The **SERIES 25** is designed for many applications. **fig. 25-01, 02, 03** show the three most common mountings.

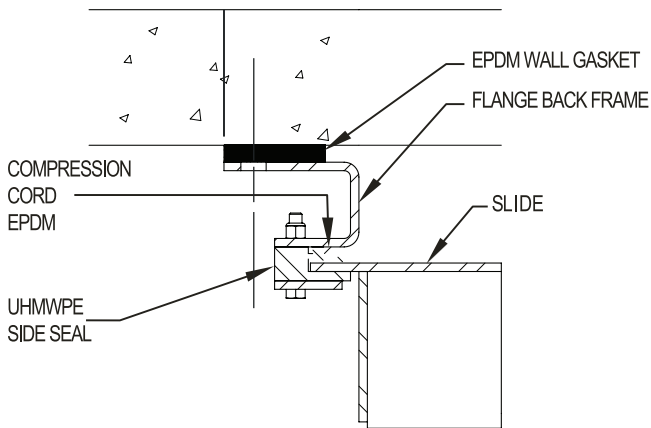

Fig. 25-02
Side section of a wall-mounted gate (CW)

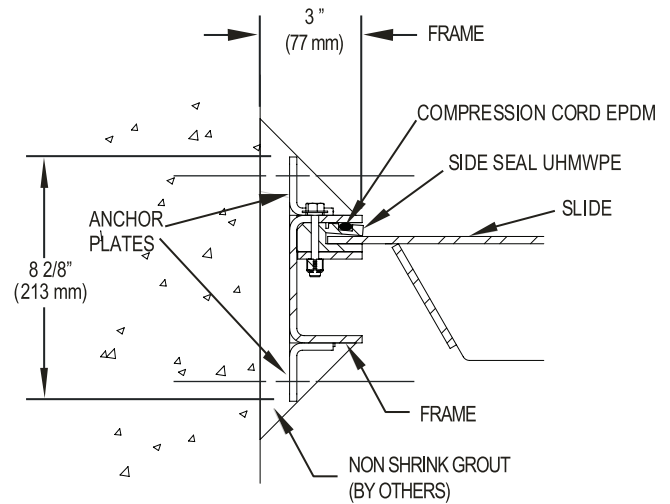

Fig. 25-03
Side section of an existing channel-mounted gate (EC)

UHMWPE Seals

The flush-bottom seal, made of resilient EPDM, leaves the opening unobstructed when the slide is in the open position. **Figures 25-04, 05, 06** show the bottom section of the channel gate installed on different kinds of channels.

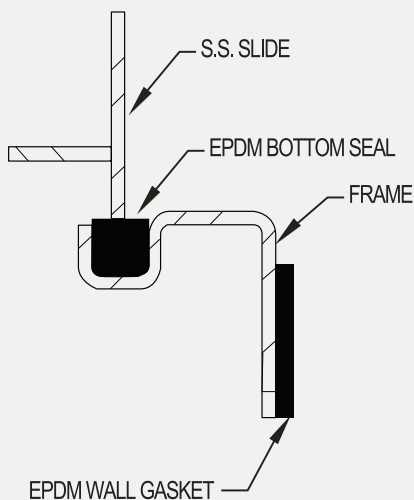

Fig. 25-05
Bottom section of a concrete wall-mounted channel gate (CW.)

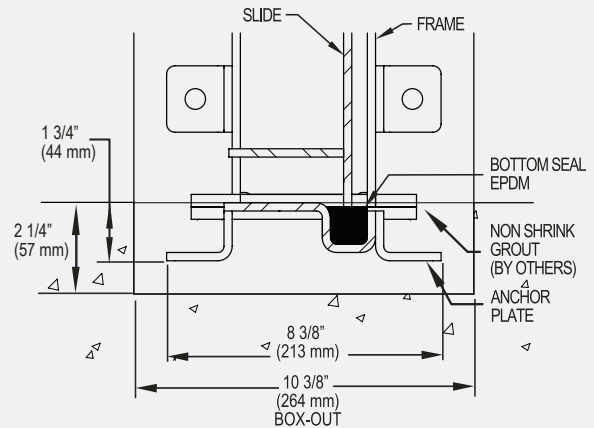

Fig. 25-04
Bottom section of an existing channel mounted gate (FE)

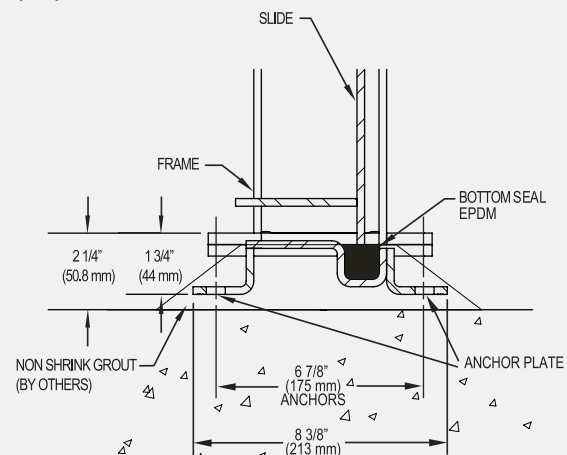

Fig. 25-06
Bottom section of an embedded frame channel gate (EC)

Frame and Stem Configuration

The following **Figures 25-07, 08 and 09** are the most common frame and stem configurations.

Model 253

Frame-embedded (FE) with yoke-mounted gear box and crank operator Rising stem

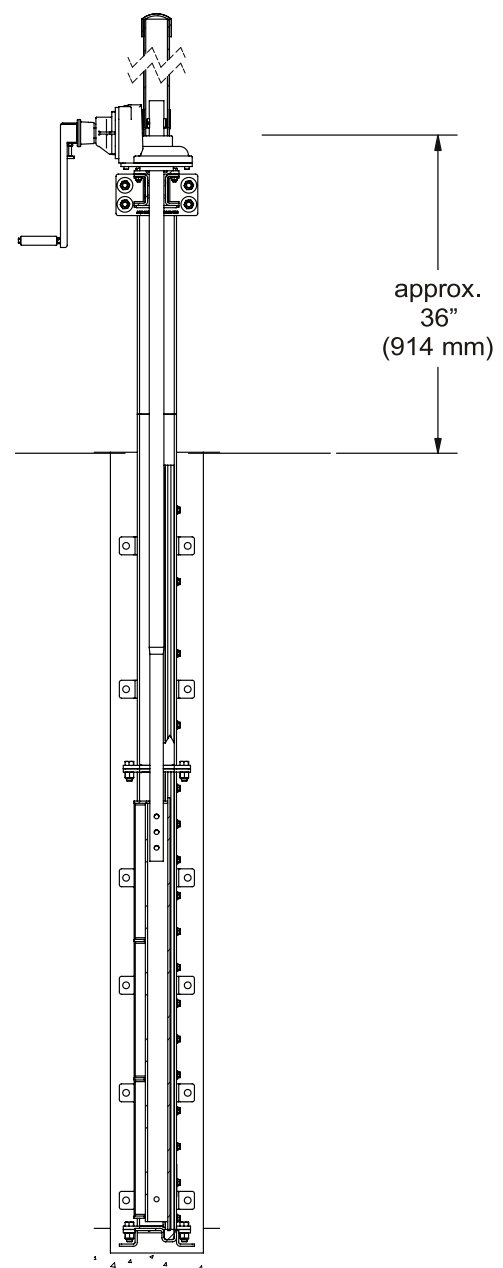
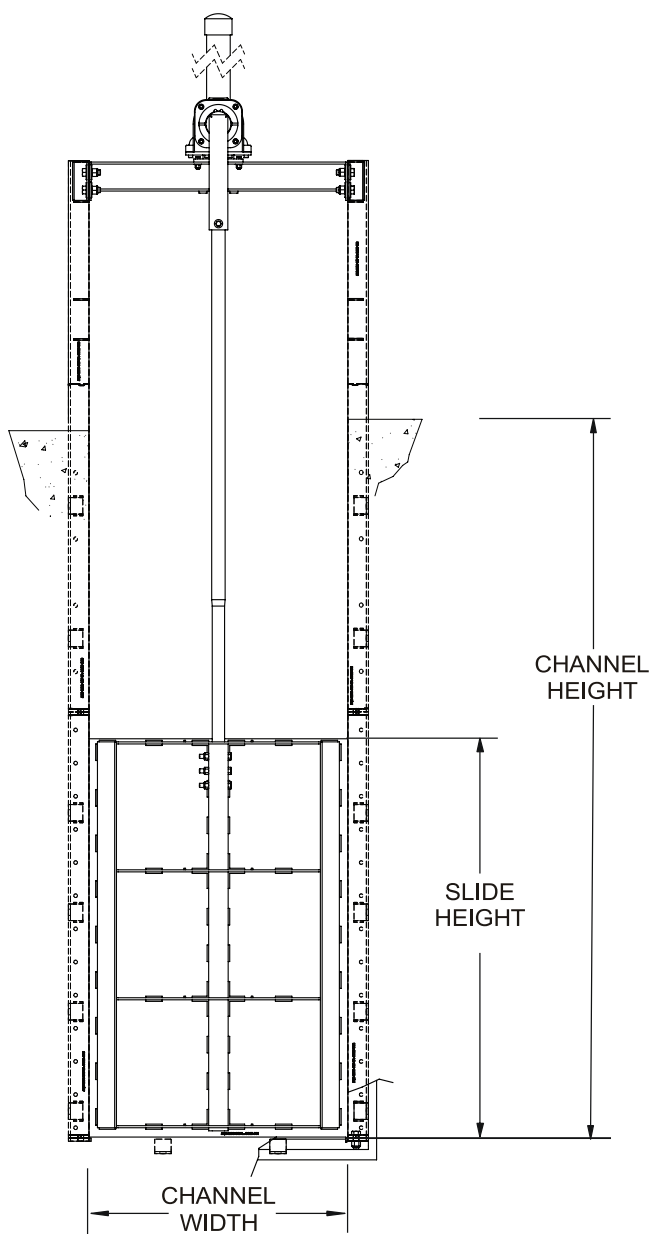

Fig. 25-07

Frame and Stem Configuration

Model 253

Wall mounted (CW) with yoke-mounted
handwheel operator
Rising stem

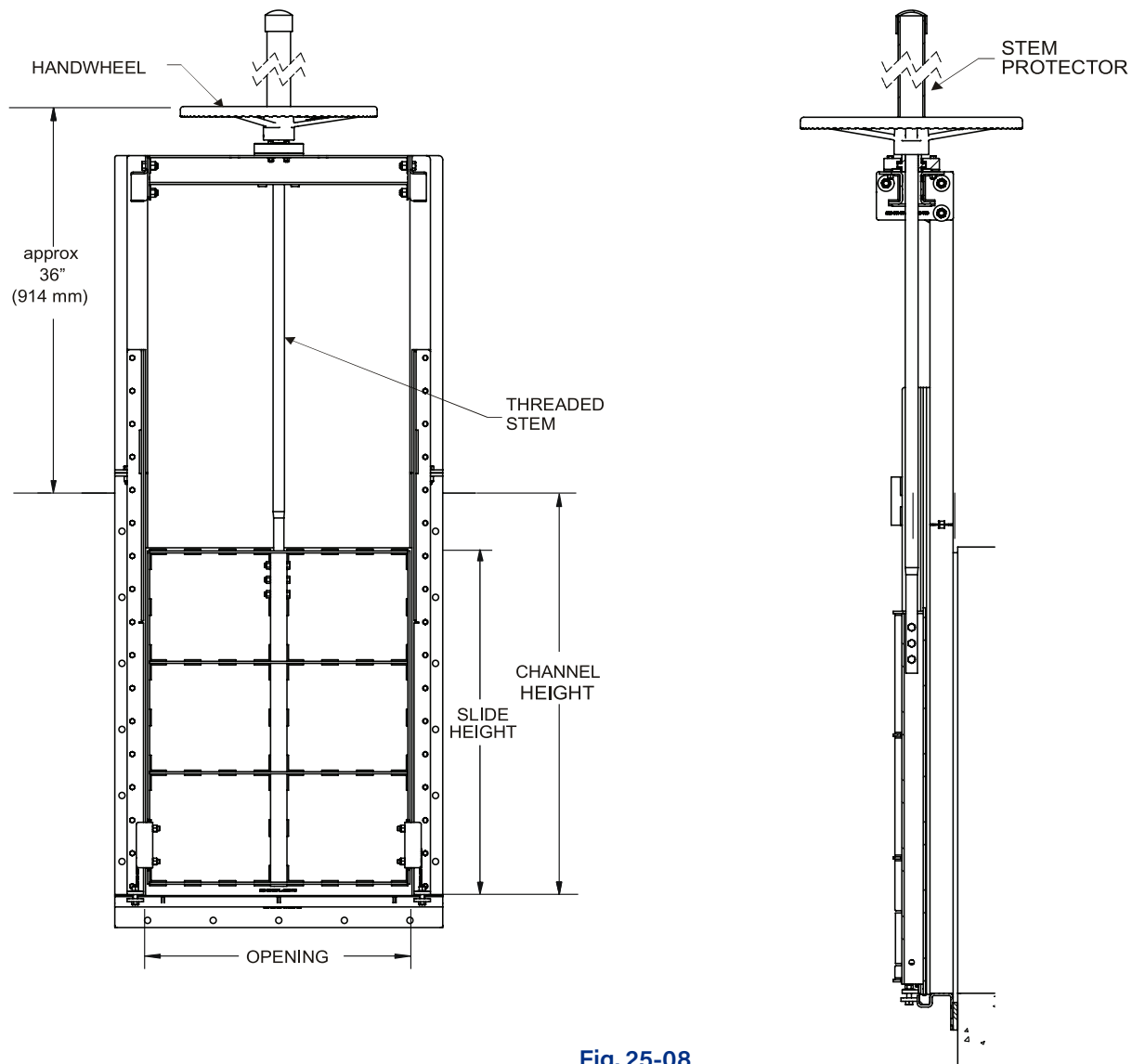

Fig. 25-08

Frame and Stem Configuration

Model 253

Inside an Existing Channel (EC) with yoke-mounted gear box and crank operator
Rising stem

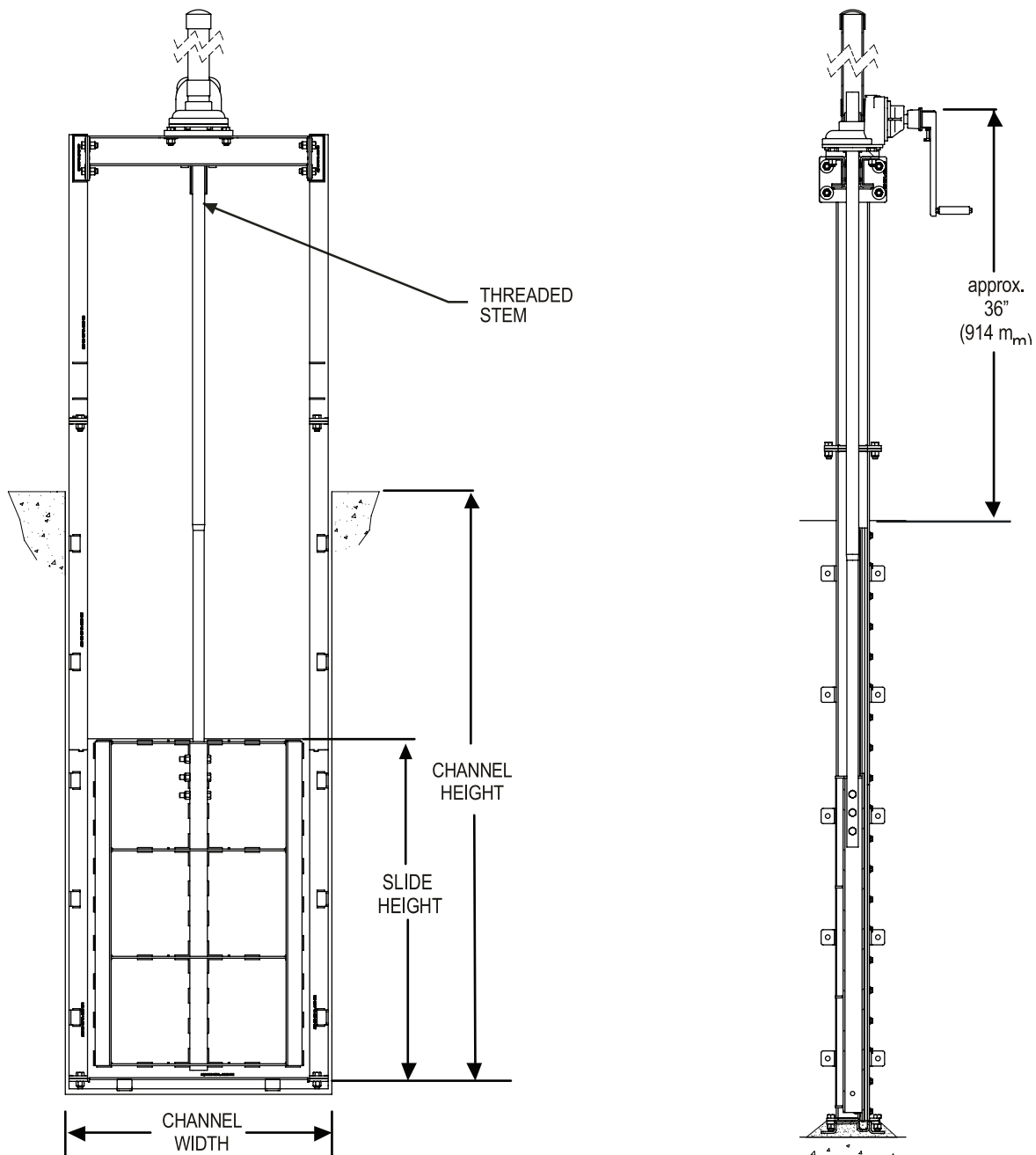

Fig. 25-09

AWWA Standards

The **SERIES 25** gates are designed to meet and exceed AWWA C561-14 standard. The result is a high-quality gate with a very long life expectancy.



**American Water Works
Association**

**As specified in the AWWA standard, all Fontaine-Aquanox
SERIES 25 water gates are tested for leakage and operation
before shipping.**

NSF-61 certification

NSF-61 certification is available on request
for **SERIE 25**.



Head office

20, Route de Windsor
Sherbrooke, Quebec Canada
J1C 0E5

Fontaine-Aquanox Plant

4065 Blvd. Portland,
Sherbrooke, Quebec Canada
J1L 1X9

Contact

1 855 769-0157
info@ISEaquanox.com
www.ISEaquanox.com