

MINI CHIC | SELECTION

DIMENSIONS, ELECTRICITY AND PLUMBING

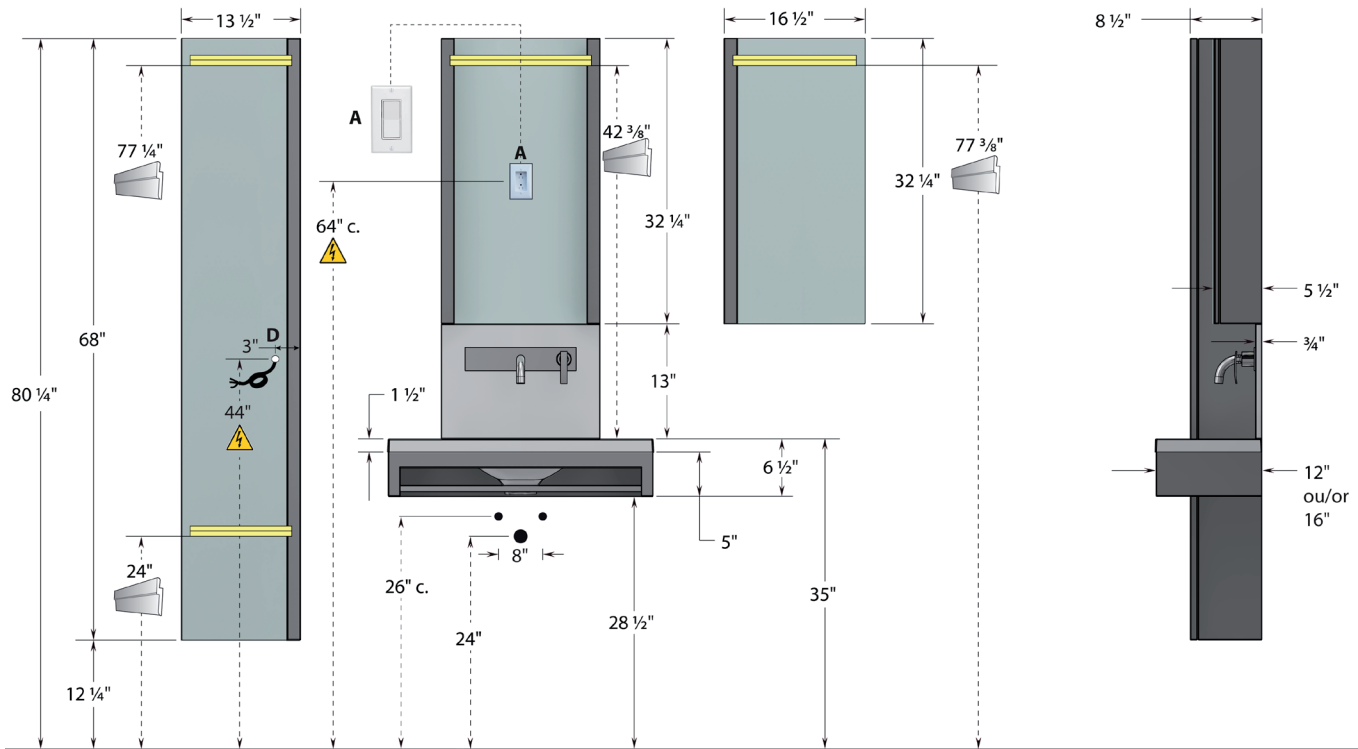

A. MAIN LED LIGHTING

Install a recessed Duplex Receptacle 15A-125V (not included) in the wall behind the mirror, powered by a 110V 3/4 wire and connected to the main switch.

D. OPTION GFCI OUTLET

Bring out a 100V 3/4 wire about 16" long, not connected to the main switch.



MINI CHIC SINK-COUNTERTOP

Not sold separately.

MINI CHIC 12" D

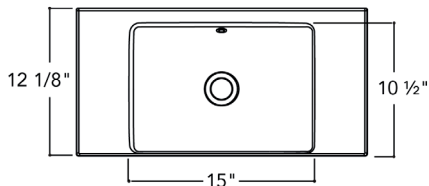

MINI CHIC 16" D

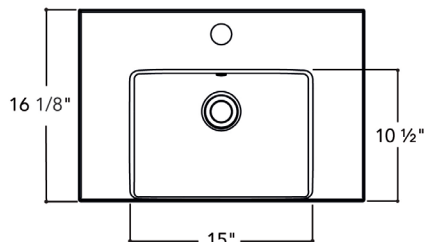

Side view

